

* 所有原材料, 生产制程, 电镀必须符合ROHS要求

Specification

MATERIAL:

Insulator: High Temperature Thermoplastic,
UL 94V-0.
Contact: Copper Alloy
Shell: Stainless Steel

PLATING:

Contact: Plated 50u" Ni Overall
Plated Au Selective Contact Area
Plated 100u" Sn Over Ni On Solder Area
Shell: Plated 50u" Ni Overall
Plated 1u" Au Over Ni On Solder Area

Property:

Current Rating :0.5mA AC/DC max.
Voltage Rating :125V AC/DC
Ambient Temperature Range :-20C~+60C
Ambient Humidity Range :95% R.H. Max.
Contact Resistance:100mΩ max.
Insulation Resistance:1000MΩ min./500VDC
Durability:10,000 cycles
Usable Memory Card:

SIM Card
PART NUMBER:

MC14-2108 X-XX R

A1:for 1u" Au plating
A3:for 3u" Au plating
A6:for 10u" Au plating
0: with mark
1: non mark

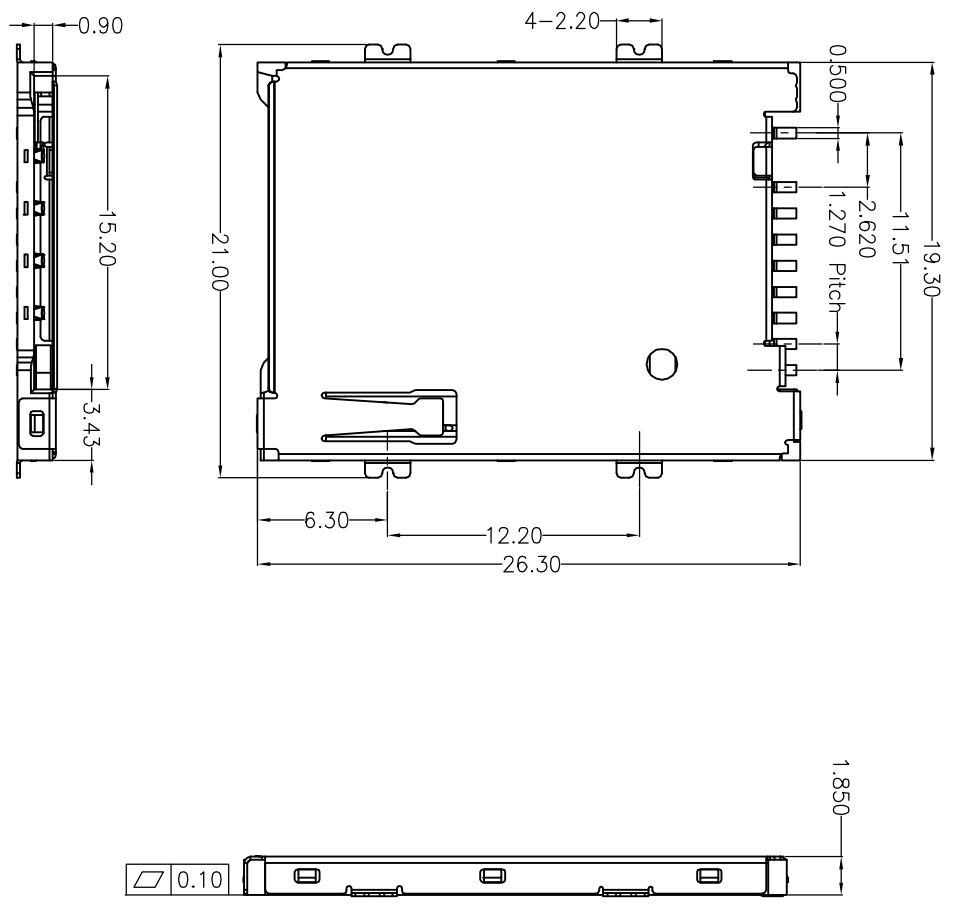

Welico T&C Co., Ltd.

DIMENSIONS INT: mm
UNLESS OTHERWISE SPECIFIABLE

DIMENSION	TOLERANCE
X.X: ±	0.38
X.XX: ±	0.25
X.XXX: ±	0.10
ANGULAR: ±	1°

PRODUCT NAME: SIM PUSH-PUSH	DRAWING: Cheney	DATE: 2009/10/15
PRODUCT NO.: MC14-2108X-XXR	CHECK: Jack	DATE: 2009/10/15
DRAWING NO.: D-MC14-2108X-XXR	APPROVED: <i>Step</i>	DATE: 2009/10/15
SCALE: 1:1	DWG ID: C D	REV.: A
		PAGE: 1 of 4

REVISION NO.	EGR NO.	DESCRIPTION	MARK	DATE
1				

PIN ASSIGNMENT:

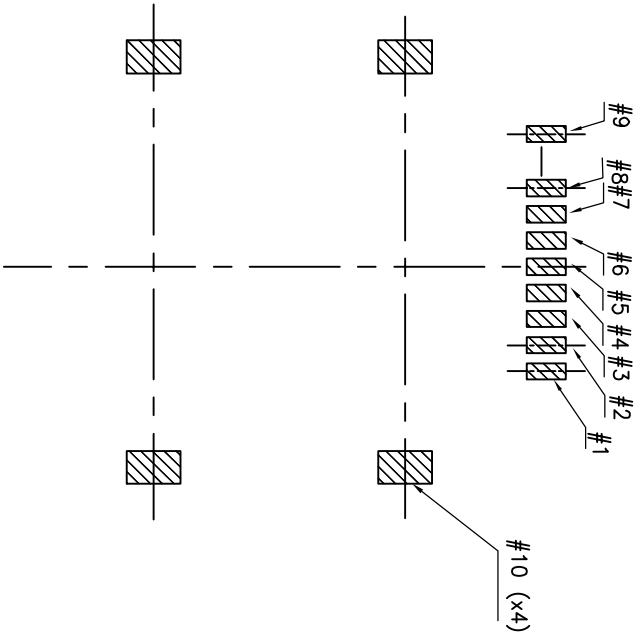

* 所有原材料, 生产制程, 电镀必须符合ROHS要求

RECOMMEND PCB LAYOUT:
(Unit:mm .X ± 0.15 .XX ±0.05 .XXX ± 0.02)

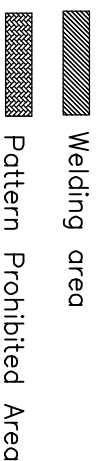
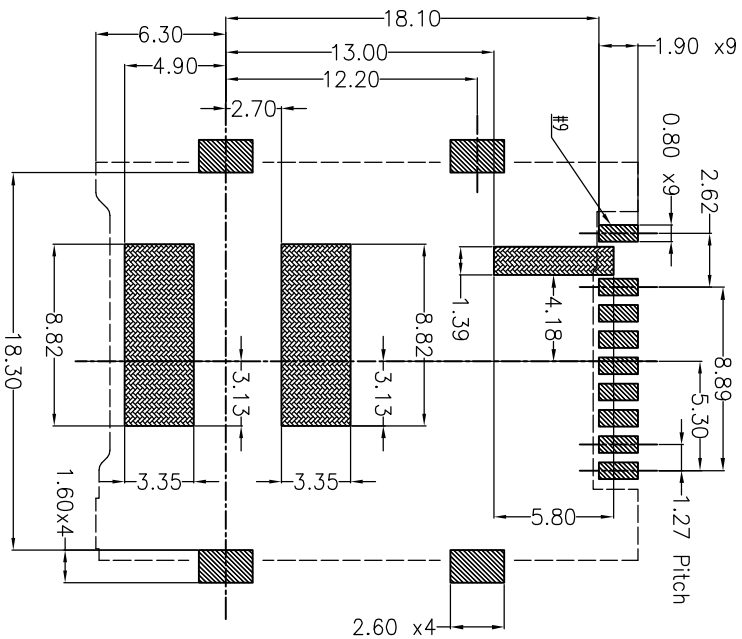

Pin Assignment Table

Pin No.	Mark	SIM Name	Mega SIM Name
#1	C1	VCC	VDD_H
#2	C5	GND	VSS_H
#3	C2	RST	URST
#4	C6	VPP	MMC_CLK
#5	C3	CLK	UCLK
#6	C7	IO	UIO
#7	C4	Reserved	MMC_DAT
#8	C8	Reserved	MMC_CMD
#9	C/D	Card Detect Switch	
#10	GND	Connector Ground	

Card Extraction : Switch Status
 Card Inserted :
 #9 —○—○— #10 #9 —○—○— #10

Welico T&C Co., Ltd.

DIMENSIONS INTI: mm
 UNLESS OTHERWISE SPECIFIABLE
 DIMENSION TOLERANCE
 X.X: ± 0.38
 X.XX: ± 0.25
 X.XXX: ± 0.10
 ANGULAR: ± 1°

PRODUCT NAME: SIM PUSH-PUSH
 PRODUCT NO.: MC14-2108X-XXR
 DRAWING NO.: D-MC14-2108X-XXR
 CHECK: Jcck
 DATE: 2009/10/15
 APPROVED: [Signature]
 DATE: 2009/10/15
 SCALE: 1:1
 DWG ID: c d
 REV.: A
 PAGE: 2 of 4

REVISION NO.	EGR NO.	DESCRIPTION	MARK	DATE
1				