

TECHNICAL CHARACTERISTICS

- General Characteristics
 Dimensions: 24.00Lx18.75WX3.50H mm
 Weight: Approx 0.70±0.1g
 Durability: 50,000 cycles min.
- Electrical Characteristics
 Contact resistance: 50mΩ typical, 100mΩ max
 Insulation resistance: >1000MΩ/500V DC
- Solderability
 Vapor phase: 215°C, 30sec. Max
 IR reflow: 250°C, 5sec. Max
 Manual soldering: 370°C, 3sec. Max
- Environmental Characteristics
 Operating temperature: -40°C~+85°C
 Operating humidity: 10%~+95%RH

ELECTRIC FUNCTION	DETECT SWITCH
WITHOUT CARD	OPEN
CARD INSERTED	CLOSED

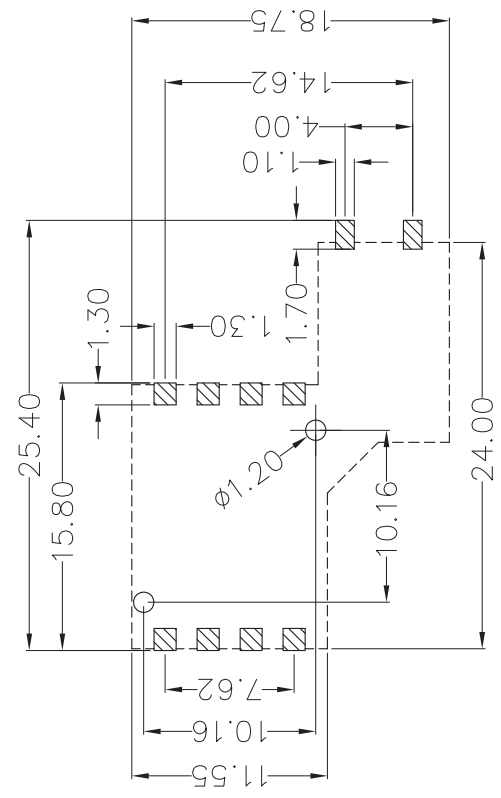
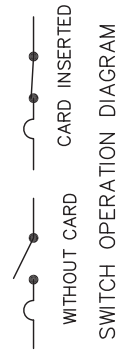

RECOMMENDED P.C.B LAYOUT
 COMPONENT SIDE (TOLERANCE ±0.05)

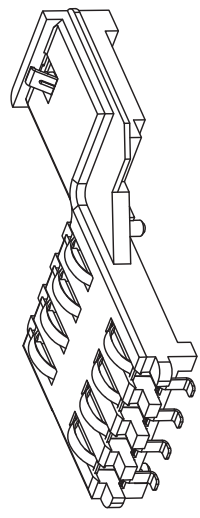

ITEM	PART NAME	QTY	MATERIAL	FINISH
1	BASE	1	Thermoplastic	Black UL94V-0
2	DATA CONTACT	8	Copper Alloy	Contact area: Gold plated
3	SWITCH CONTACT 2	1	Copper Alloy	Contact area: Gold plated
4	SWITCH CONTACT 1	1	Copper Alloy	Contact area: Gold plated

Wellco T&C Co., Ltd.

IC Card Acceptor

NAME: **737**

MODEL NO: **H3.50mm**

TYPE :

DRAWN	Zoey	2012.02.15	DWG NO.:	737-002
CHECKED	Keey	2012.02.15		REVISION
APPROVAL	Simon	2012.02.15		SHEET 1/1
				REVISION X1

Unless otherwise specified, other tolerance are:

X	±0.35	X'	±5'
X.X	±0.25	X.X'	±4'
X.XX	±0.15	X.XX'	±3'
X.XXX	±0.10	X.XXX'	±2'

PROJ. UNIT SCALE 1:1

CUSTOMER DRAWING

