

ROHS

ITEM	PART NAME	MATERIAL	NUM	COLOR	FINISHING	REMARK

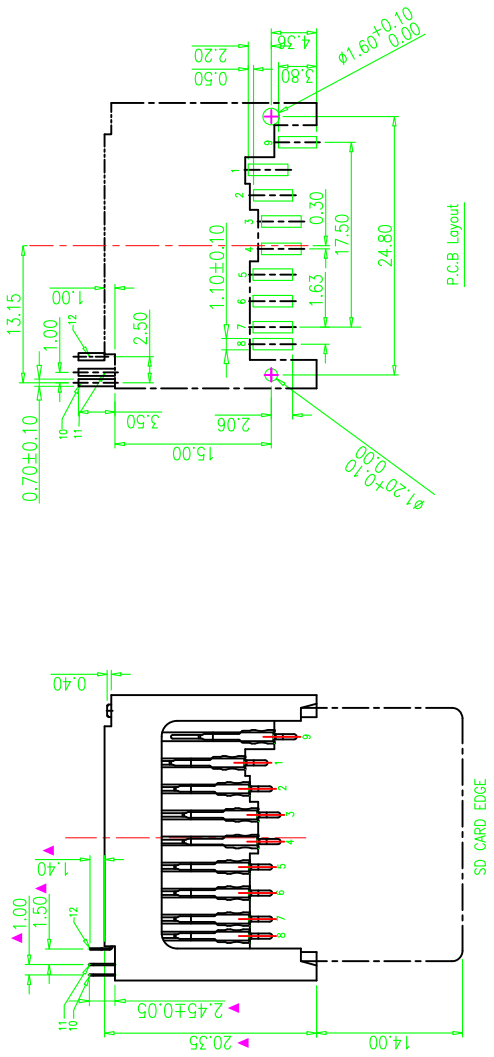

P.C.B Layout

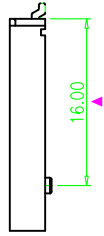
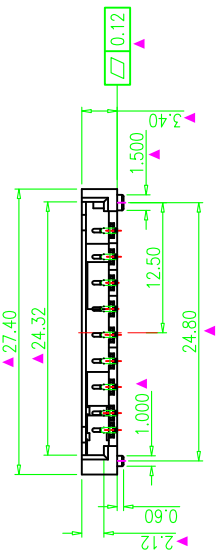

- Note:
- 1.Material:
- 1.1 Insulator: High temperature thermoplastic with g.f,UL94v-0
  - 1.2 Contact: Copper alloy,t=0.20mm
  - 1.3 Mounting ear: Copper alloy,t=0.20mm
- 2.Specification:
- 2.1 Current rating: 0.5 A Max.
  - 2.2 Voltage rating: 250 VRMS
  - 2.3 Contact resistance: 100 millioHMS
  - 2.4 Dielectric withstanding voltage: 500 V(ac) for 1 min.
  - 2.5 Insulation resistance:100 MegOHMS
  - 2.6 Operation temperature range:-25° C~90°

THE DIMENSIONS MARKED "▲" SHALL BE CHECK BY Q.C.

PIN NO	Name	Description
1#	CD/DAT3	Card detect/Data 1/0 Command
2#	CMD	
3#	VSS1	Ground
4#	VDD	Power
5#	CLK	Clock
6#	VSS2	Ground
7#	DAT0	Data1/0
8#	DAT1	Data1/0
9#	DAT2	Data1/0



WITHOUT CARD



CARD INSERTED  
WRITE PROTECT LOCK  
10-WRITE PROTECT PIN  
11-COMMON PIN  
12-CARD DETECT PIN



CARD INSERTED  
WRITE PROTECT UNLOCK

# P/N # 181-4209

Part No: 181-42091002011-02

## Wellco T&C Co., Ltd.

ARTICLE: SD CARD全塑短型 BK



PROJECTION

MODEL 181-00003

REV: A

SHEET: 1/1

UNIT: mm

SCALE: 1:1

6

5

4

3

2

1