

1	2	3	4	5	6	7	8												
<p><b>NOTES:</b></p> <p><b>ELECTRICAL:</b></p> <ul style="list-style-type: none"> <li>1. VOLTAGE RATING : 125VAC RMS</li> <li>2. CURRENT RATING : 1.5 AMP</li> <li>3. CONTACT RESISTANCE : 50 MILLIOHMS MAX</li> <li>4. INSULATION RESISTANCE : 500 MEGOHMS MIN @500 VDC</li> <li>5. DIELECTRIC STRENGTH : 1000 VAC RMS 50HZ.1MIN</li> </ul> <p><b>MECHANICAL:</b></p> <ul style="list-style-type: none"> <li>1. HOUSING MATERIAL : GLASS FILLED POLYTER(U/L94V-0)</li> <li>2. CONTACT MATERIAL : PHOSPHOR BRONZE T=0.46MM</li> <li>3. PLATING : GOLD PLATION OVER NICKEL</li> <li>4. OPERATION LIFT : 750 CYCLES MIN</li> <li>5. PCB RETENTION PRE-SOLDER:1 LBMIN</li> <li>6. PCB RETENTION POST-SOLDER:10 LBMIN</li> </ul> <p><b>ENVIRONMENTAL:</b></p> <ul style="list-style-type: none"> <li>1. STORAGE : -40°C TO +85°C</li> <li>2. OPERATION : 0°C TO +70°C</li> <li>3. WAVE SOLDER TEMPERATURE:230~250°C(5~10SECONDS)</li> </ul> <p>MATES WITH MODULAR PLUG CONFORMING TO FCC PART68 SUBPART F</p>		<p><b>PART NUMBER:</b></p> <p><b>XA55C2-XX-XXXXXX</b></p>		<p>55C2 SERIES PCB JACK (55C2系列PCB插头)</p> <p>POSITIONS (位槽):</p> <ul style="list-style-type: none"> <li>4-4POSITIONS (4P). 6-6POSITIONS (6P)</li> <li>8-8POSITIONS (8P). 0-10POSITIONS (10P)</li> </ul> <p>CONTACTS (接触脚):</p> <ul style="list-style-type: none"> <li>2-2CONTACTS (2C)</li> <li>4-4CONTACTS (4C). 6-6CONTACTS (6C)</li> <li>8-8CONTACTS (8C). 0-10CONTACTS (10C)</li> </ul> <p>PORTS (端口):</p> <ul style="list-style-type: none"> <li>1-1X1 (单). 2-1X2 (双)</li> <li>4-1X4 (四). 5-1X5 (五)</li> <li>6-1X6 (六). 8-1X8 (八)</li> </ul> <p>SHIELD (屏蔽):</p> <ul style="list-style-type: none"> <li>0-W/O SHIELD (非)</li> <li>1-HALF SHIELD (半)</li> <li>2-SHIELD W/EMI (带屏蔽)</li> <li>3-SHIELD W/O EMI (不带屏蔽)</li> </ul> <p>GOLD PLATING (镀金):</p> <ul style="list-style-type: none"> <li>1-FU". 2-3U"</li> <li>3-6U". 4-15U"</li> <li>5-30U". 6-50U"</li> </ul> <p>PLASTIC (塑料):</p> <ul style="list-style-type: none"> <li>1-PBT. 2-NYLON66 (尼龙66)</li> <li>3-NYLON46 (尼龙46). 4-ABS</li> </ul> <p>PIN STYLE (针型):</p> <ul style="list-style-type: none"> <li>1-ROUND PIN (圆针)</li> <li>2-FLAT PIN (扁针)</li> </ul> <p>PEG/TAB (定位脚):</p> <ul style="list-style-type: none"> <li>0-W/O PEG (非)</li> <li>1-FRONT PEG3.05 (前脚3.05)</li> <li>2-FRONT PEG3.68 (前脚3.68)</li> <li>3-FRONT PEG4.57 (前脚4.57)</li> <li>4-BACK PEG3.05 (后脚3.05)</li> <li>5-BACK PEG3.68 (后脚3.68)</li> </ul>		<p>公差 (TOLERANCE):</p> <table border="1"> <tr> <th>公差 (TOLERANCE)</th> <th>公差 (TOLERANCE)</th> </tr> <tr> <td>MM</td> <td>MM</td> </tr> <tr> <td>.0 ± 0.20</td> <td>.0 ± 0.38</td> </tr> <tr> <td>.00 ± 0.15</td> <td>.00 ± 0.25</td> </tr> <tr> <td>.000 ± 0.075</td> <td>.000 ± 0.15</td> </tr> </table> <p>角度 (ANGLES) ± 1.5°</p> <p>第三角视图</p>		公差 (TOLERANCE)	公差 (TOLERANCE)	MM	MM	.0 ± 0.20	.0 ± 0.38	.00 ± 0.15	.00 ± 0.25	.000 ± 0.075	.000 ± 0.15	<p><b>Wellco T&amp;C Co., Ltd.</b></p> <p>名称 (NAME): XA55C2-66-100111</p> <p>系列 (SERIES):</p> <p>图号 (DWG NO.):</p> <p>料号 (PART NO.): XA55C2-66-100111</p> <p>单位 (UNIT): MM 共(SHEET) 1 页 集(OFF) 1 页</p> <p>原稿 REV. A0</p>	
公差 (TOLERANCE)	公差 (TOLERANCE)																		
MM	MM																		
.0 ± 0.20	.0 ± 0.38																		
.00 ± 0.15	.00 ± 0.25																		
.000 ± 0.075	.000 ± 0.15																		

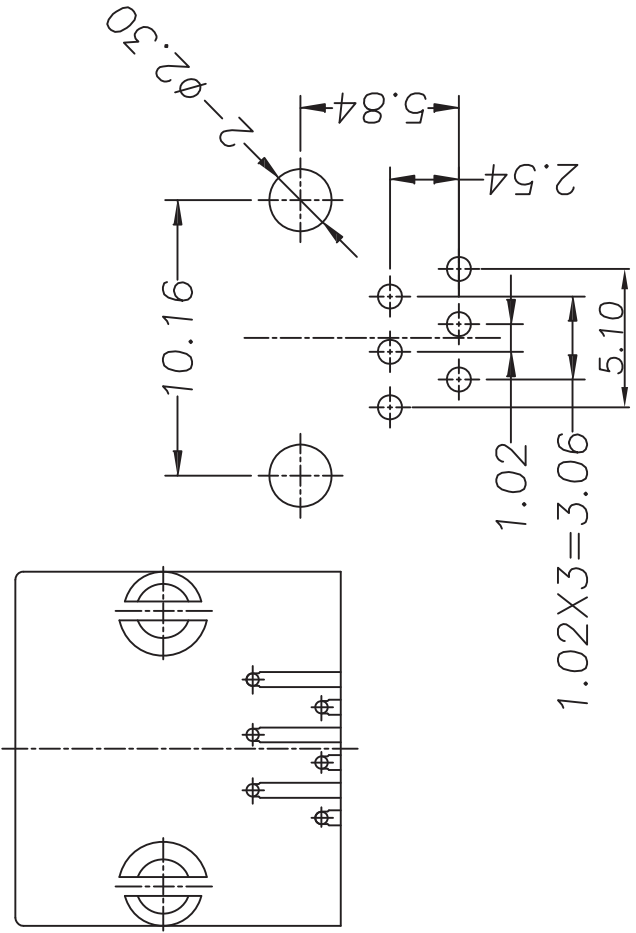
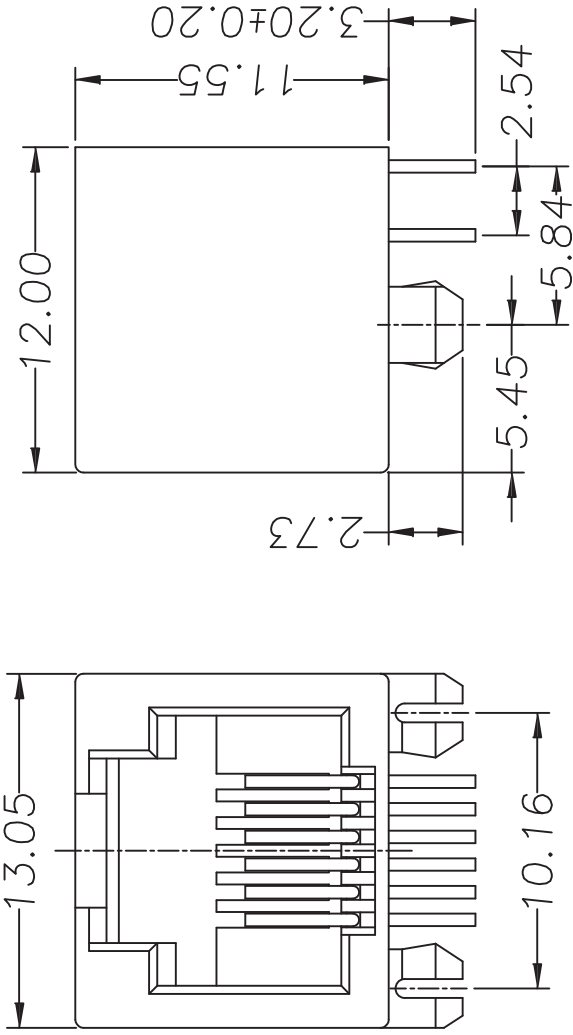

**PC Board Layout**