

# SPECIFICATION FOR APPROVAL



PRODUCT NAME: 59 1\*1port with transformer and EMI  
,W/O LED , 10/100BT: SMD

NEW PRODUCT NO: JSFD10170000

OLD PRODUCT NO: TM-10017

CUSTOMER NO :

REV : 02 DATE :

Wellco		
Issued By	Checked By	Approved By

Customer		
Customer Approval: <input type="checkbox"/> Approved <input type="checkbox"/> Conecssionary <input type="checkbox"/> Rejected		
Issued By	Checked By	Approved By

# Wellco T&C Co., Ltd.



REV	DISCRITION	DATE
01	ISSUE FIRSTLY	2009.11.02
02	= 3.18> 9.06?@A 3.6> 8.4	2011.07.20

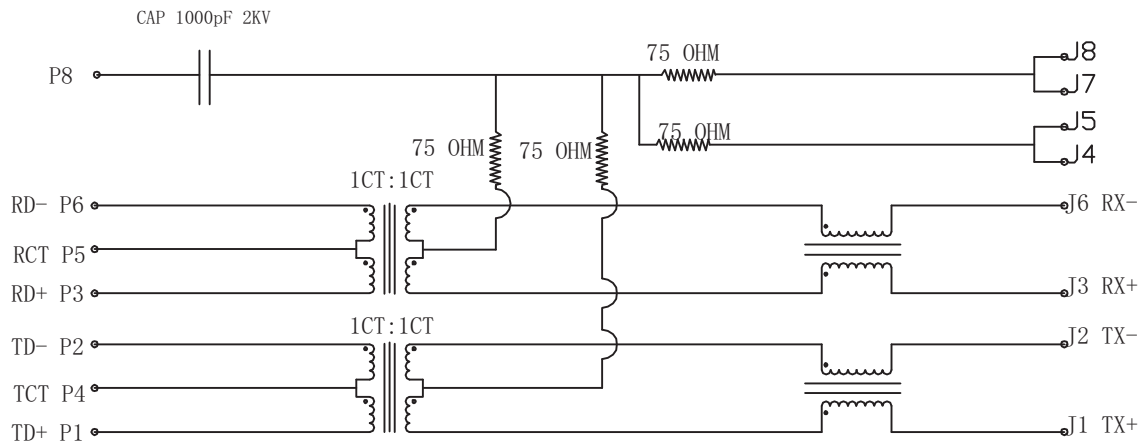

ALL THE RAW MATERIALS MEET RoHS STANDARD

### ELECTRICAL SPECIFICATIONS @25< C:

- 1.0 TURN RATIO: (P1~P2) : (J1~J2) : 1:1; 3%  
(P3~P6) : (J3~J6) : 1:1; 3%
- 2.0 INDUCTANCE: (P1~P2) AND (P3~P6) 350uH MIN @0.1V, 100KHZ, 8mA DC BIAS
- 3.0 LEAKAGE INDUCTANCE: P1~P2 (WITH J1 AND J2 SHORT) : 0.35uH MAX @1MHZ  
P3~P6 (WITH J3 AND J6 SHORT) : 0.35uH MAX @1MHZ
- 4.0 INTERWINDING CAPACITANCE: (P1~P2) : (J1~J2) : 35pF MAX @ 1MHZ  
(P3~P6) : (J3~J6) : 35pF MAX @ 1MHZ
- 5.0 DC RESISTANCE: (J1~J2) : (J3~J6) : 1.2 OHMS MAX
- 6.0 RETURN LOSS: 1MHZ TO 30MHZ : -18dB MIN  
30MHZ TO 60MHZ : -(18-20log(f/30))dB MIN (WHERE f IS IN MHZ)  
60MHZ TO 80MHZ : -12dB MIN
- 7.0 DIELECTRIC WITHSTAND: (P1~P2) : (J1~J2) : 1500VAC OR 2250VDC  
(P3~P6) : (J3~J6) : 1500VAC OR 2250VDC
- 8.0 INSERTION LOSS: 100KHZ TO 100MHZ : -1.2dB MAX
- 9.0 CROSS TALK: 1MHZ TO 100MHZ : -35dB TYP
- 10.0 COMMON TO COMMON MODE ATTENUATION: 30MHZ TO 100MHZ : -30dB TYP

DWN	Ding Wen Min 2011.07.20	SIZE	A4	DRAWING NO.	JSFD10170000	REV	02
CHK		SCALE	N/A			SHEET	2 OF 3
APVD	DaVid						

# MECHANIC SPECIFICATIONS:



REV	DISCRITION	DATE
01	ISSUE FIRSTLY	2009.11.02
02	将3.18和9.06更改为3.6和8.4	2011.07.20

**NOTES:**

- CONNECTOR MATERIAL:  
HOUSING: THERMOPLASTIC UL94 V-0  
CONTACT/SHIELD: COOPER ALLOY  
SHIELD PLATING: NICKEL 30 MICRO-INCHS MIN  
CONTACT PLATING: SELECTIVE GOLD,  
50 MICRO-INCHS MIN  
30 MICRO-INCHS MIN  
15 MICRO-INCHS MIN  
6 MICRO-INCHS MIN  
3 MICRO-INCHS MIN  
IN CONTACT AREA
- PIN NOT ELECTRICALLY CONNECTED MAYBE OMITTED SEE ELECTRICAL DRAWING FOR OMITTED PINS.
- RJ45 CAVITIES CONFORM TO FCC RULES AND REGULATION PART 68 SUBPART F.
- THE PART IS RECOMMENDED FOR WAVE SOLDERING PROCESS PEAK SOLDERING TEMPERATURE IS 260 ° C MAX, 10 SECS MAX
- OPERATING TEMPERATURE T=0 ° C TO +70 ° C.
- STORAGE TEMPERATURE T=-40 ° C TO +85 ° C.
- ALL TOLERANCES NOT OTHERWISE SPECIFIED TO BE ±0.25mm.

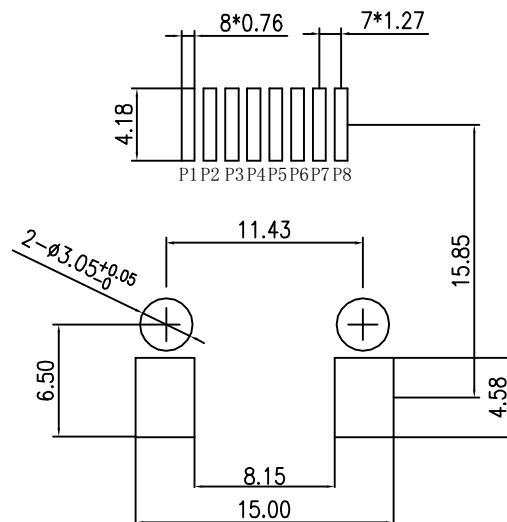
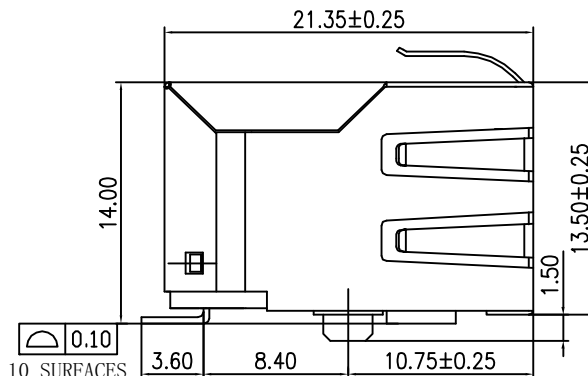
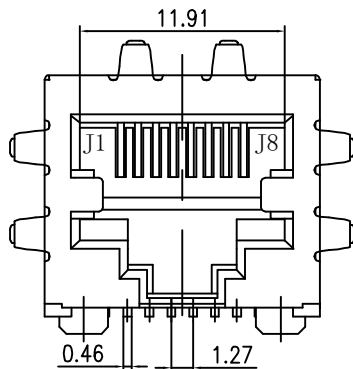
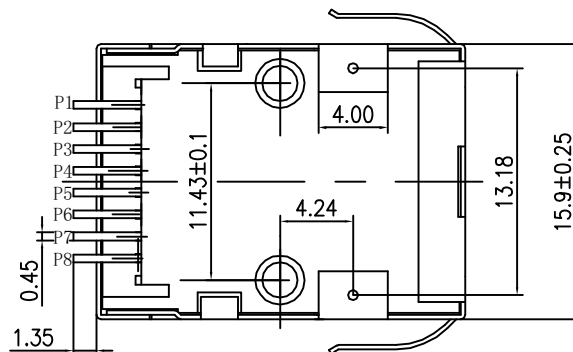

Ordering informer:  
TM-10017-0XX

See Sheet

Material Plastic:  
N: whitout Haloid.  
H: with Haloid

Code	Housing Colour	Housing Material	Insertor Colour	Insertor Material
Z	Black	PBT	Black	PBT
Y	Black	PBT	Yellow	PBT
W	Yellow	PBT	Black	PBT
U	Yellow	PBT	Yellow	PBT
T	Black	PA66	Black	PBT
S	Black	PA66	Yellow	PBT
R	Yellow	PA66	Black	PBT
Q	Yellow	PA66	Yellow	PBT
P	Black	PA46	Black	PBT
O	Black	PA46	Yellow	PBT
N	Yellow	PA46	Black	PBT
M	Yellow	PA46	Yellow	PBT

P. C. B RECOMMENDED HOLE LAYOUT SEEN FROM COMPONENT SIDE.

ALL CENTERLINE DIMENSIONS ARE BASIC

DWN	Ding Wen Min 2011.07.20	SIZE A4	DRAWING NO. JSFD10170000	REV 02
CHK		SCALE N/A		SHEET 3 OF 3
APVD	DaVid			