

Electrical:
 1. Voltage Rating: 125 Vac Rms.
 2. Current Rating: 1.5 Amp.
 3. Contact Resistance: 40 Milliohms Max.
 4. Insulation Resistance: 1000 Megohms Min @ 500 Vdc.
 5. Dielectric Strength: 1000 Vac Rms 60Hz, 1Min.

Mechanical:
 1. Operating: 750 Cycles Min.
Environmental:
 1. Storage: -40°C To +85°C
 2. Operation: -20°C To +75°C
 Mates With Modular Plug Conforming To FCC Part 68, Subpart F.

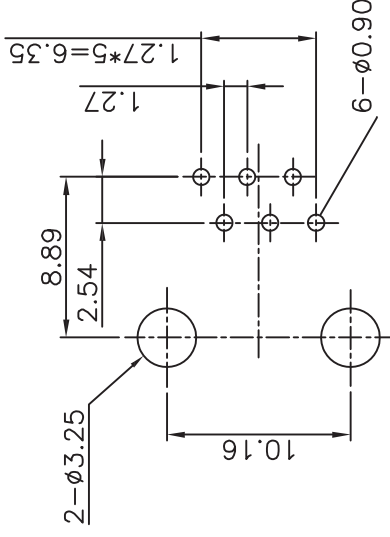
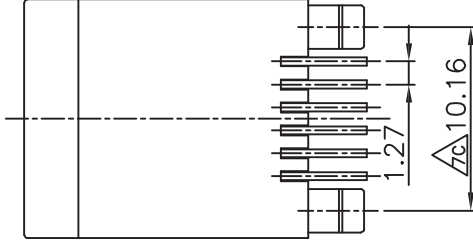
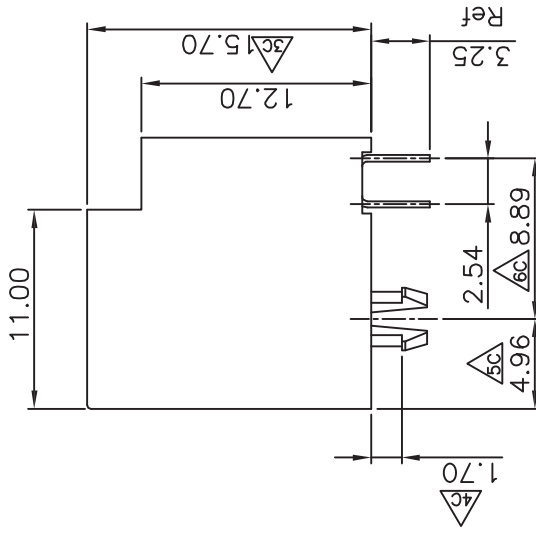

PCB LAYOUT/TOP VIEW

MATERIALS:
 PLASTIC HOUSING: ENGINEERING THERMOPLASTIC
 FLAMMABILITY RATING UL 94V-0.
 CONTACTS: PHOSPHOR BRONZE
 PLATING: GOLD PLATING OVER NICKEL IN CONTACT.
 TIN PLATING OVER NICKEL IN SOLDER AREA.

P/N # RJ66-0701

Wellco T&C Co., Ltd.

系列 (SERIES) 名称 (NAME)

TOP ENTRY PCB TH JACK (有断差6P6C)

图号 (DWG NO.):
 料号 (PART NO.): **PIN # RJ66-0701**
 单位 (UNIT): MM 共 (SHEET) 1 页 第 (OF) 1 页

版本 (REV.): A0

公差: TOLERANCES	绘图: (Desigined)
MM 0.0 ± 0.25 0.15 ± 0.15 0.00 ± 0.05	审核: (Checked)
角度 (ANGLES) ± 1.5°	批准: (Approved)
第三角视图	材料: (Material) SEE NOTES
	比例: (SCALE) 1:1

1	2	3	4	5	6	7	8
A	B	C	D	E	F	G	H
REV.	ECN. NO.	NAME	DATA				
A0	NEW	MIN-D	2012-8-19				
			1		鹏		